



Radio Frequency Do's & Don'ts

Please read before installing !

Almost all of us have used a cordless phone, cellular phone, or FRS radios by now. They all work with the same principles as our wireless products only they have the advantage of us listening to hear when we are in a bad location by hearing static or noise and knowing we have to move closer or move to a hill (higher) to acquire better signal reception. Radio frequency (wireless) in simple terms consists of a transmitter and a receiver. Our transmitters send data via radio frequency (wireless) to the receiver (inside) triggering a tone or alert inside your home. Line of sight with no obstructions between outside device and inside receiver are always favorable for the best results. 98% of our tech support phone calls are asking why my sensor isn't working or is intermittent in sensing. And 98% of the time it is poor communications between outside sensor and inside receiver. A good example is using your cordless phone or cell phone and stepping one direction or the other to sound clear or full of static and noise. The difference is you are able to hear the noise and adjust your location. Because our devices send data, the only way to determine "noise" or "static" is by your system not "beeping" or intermittent and/or erratic operation.

Learn how your sensing device works by trying it first in your house before mounting it at the location that you want to install it. All variables are less of a factor the closer the receiver and sensor are to each other. In other words it is more critical at 700 foot distance than at 100 foot distance from transmitter to receiver.

Do's

- Mount the receiver as high as possible in your home.
- Make transmitter to receiver as clear of obstructions as possible.
- Try your sensor and receiver inside before mounting to understand how unit operates.
- Set the receiver at a window on the same side of the house as the sensor.

Don'ts

- Do not set the receiver on the floor inside your home.
- Do not place the receiver in a basement.
- Do not set your receiver next to cordless phones, computers, or any other electronic devices.
- Do not set the receiver next to metal devices.
- Do not mount the outside sensor on metal.
- Do not set your outdoor sensor on the ground to test.

Other Wireless Facts:

- Steel or aluminum siding can greatly reduce range of transmitter to receiver range.
- Metalized Celotex under siding or brick can have a huge effect on reduction of range.
- Brick and masonry will have a substantial range reduction.
- Height is a huge factor in performance of transmission distance.
- Glass windows provide the least resistance to radio frequency.
- Always try to place your receiver at a window on the same side of your home as the sensor outside.
- The closer the sensor is to the receiver, the less that the above play into as factors.
- Mounting an outdoor sensor over a hill has the most reducing effect of radio frequency distance.
- Usually small receiver relocations are all that is needed.
- 2nd story placement of the receiver can result in a huge distance increase if applicable.
- Maximum height and minimum obstructions are the largest benefit in range.
- Our units distance are rated line of sight average. You can experience more or less range than rated.
- Weather conditions can also change performance of distance.
- Over a period of time range can slightly degrade as product ages, frequencies of product slightly shift, foliage growth, or local RF interference changes. You may need to relocate the sensor closer to the receiver.

Xtralert

Long Range Digital Sensor

Installation and Operation Manual

Outdoor Sensor With Front Panel Removed

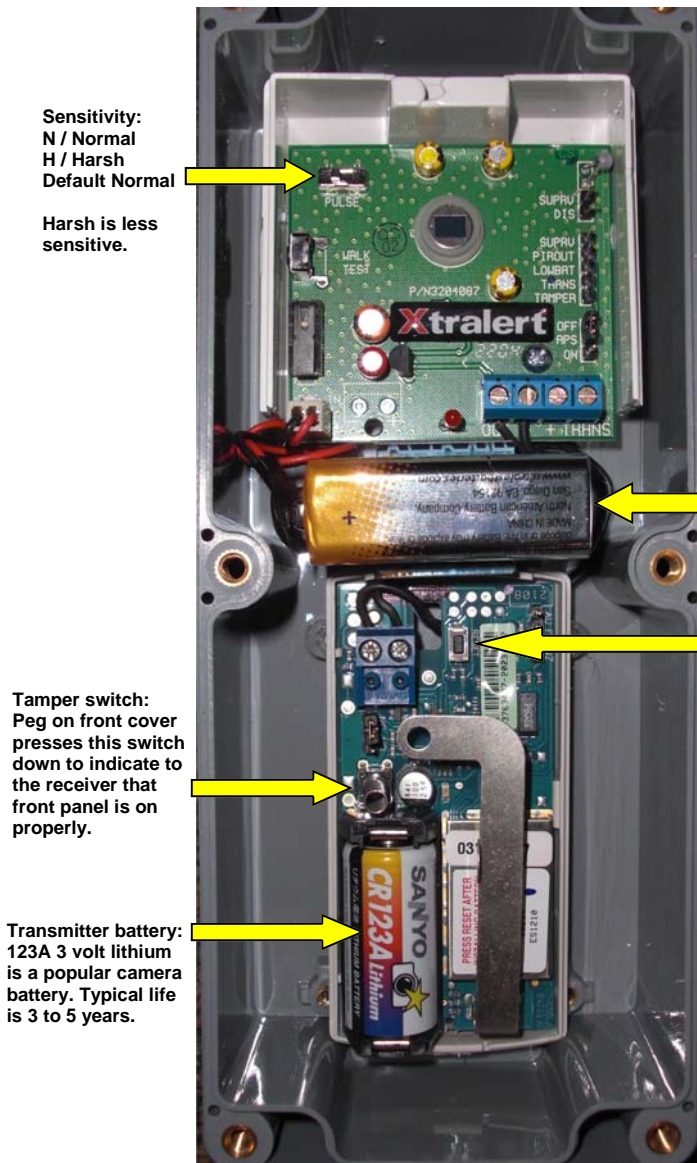

Sensitivity:
N / Normal
H / Harsh
Default Normal

Harsh is less sensitive.

Tamper switch:
Peg on front cover presses this switch down to indicate to the receiver that front panel is on properly.

Transmitter battery:
123A 3 volt lithium is a popular camera battery. Typical life is 3 to 5 years.

The Xtralert digital transmission outdoor sensor is the most reliable system on the market today which includes exclusive wireless supervision, a NEMA4x weather tight 6 screw enclosure, digital signal transmission, and the highest battery life by years over others.

The added cost initially is well saved money over the long term as battery changing is greatly reduced as much as 10 times, saving you valuable time and money. Other features include a more reliable interference free digital signal, stealth mount bracket system, field replaceable front lens, and the only industry standard NEMA4X weatherproof enclosure.

Digital supervision alerts you if there is a transmitter problem with communication from the sensor to the receiver enhancing reliability to know your system is working when you may need it at the most critical time.

Typical line of sight range can be up to one mile. Conditions will vary but it is rare not to achieve at least 2000 feet on a regular basis even with obstructions. Terrain followed by metal buildings will decrease wireless range the most.

Sensor battery:
Standard 9 volt alkaline or lithium.
Alkaline life 3 to 4 years
Lithium 9 volt about 5 to 6 years.

Transmitter Reset:
Press after changing 123A lithium battery below.

Do not use cordless drivers on the 6 screw front case. Overtightening will crack the case and allow moisture to enter. Tighten firmly.

You will not damage the sensor if mounting it on a metal surface but a range reduction can be expected in this application. If the inactive light illuminates on your receiver in approximately 8 hours you must relocate the sensor and or receiver for better communication.

Tip the sensor slightly down to avoid triggers such as swaying trees or distant traffic.

Do not point sensor towards direct heat sources, moving objects, or high light reflections.

Warranty/Disclaimer

Jansen Electronics "JE" warrants its products ("Product" or "Products") to conform to its own specifications and to be free of defects in materials and workmanship under normal use for a period of 12 months (unless otherwise stated) from the date of purchase. Within the warranty period, JE will repair or replace, at its option, all or any part of the warranted product. JE will not be responsible for dismantling and or reinstallation charges. To exercise the warranty, the user ("user", "installer" or "consumer") must contact JE and receive a Return Material Authorization ("RMA") number by JE. This warranty is void in cases of improper installation, misuse, failure to follow installation and operating instructions, alteration, accident or tampering and repair by anyone other than JE.

This warranty is exclusive and expressly in lieu of all other warranties, obligations or liabilities, whether written, oral, express, or implied. There is no warranty by JE that JE product will be merchantable or fit for any particular purpose, nor is there any other warranty, expressed or implied, except as such is expressly set forth herein. In no event shall JE be liable for an incidental, consequential, indirect, special or exemplary damages, including but not limited to loss of profit, revenue, or contract, loss of use, cost of down time, or interruption of business, nor any claim made by distributor's customers or any other person or entity. This warranty will not be modified or extended. JE does not authorize any person to act on its behalf to modify or extend this warranty. This warranty will apply only to JE products. JE will not be liable for any direct, incidental or consequential damage or loss whatsoever, caused by the malfunction of product due to products, accessories, or attachments of other manufacturers, including batteries, used in conjunction with JE products.

Caution: Changes or modifications to this unit not expressly approved by Jansen Electronics may void the installer's authority to operate the equipment as well as the product warranty.

Xtralert

Long Range Digital Sensor

Installation and Operation Manual

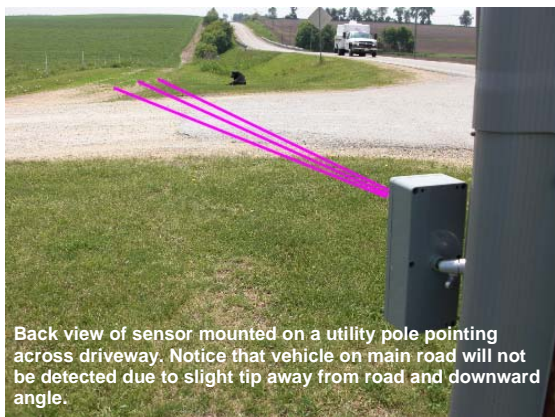
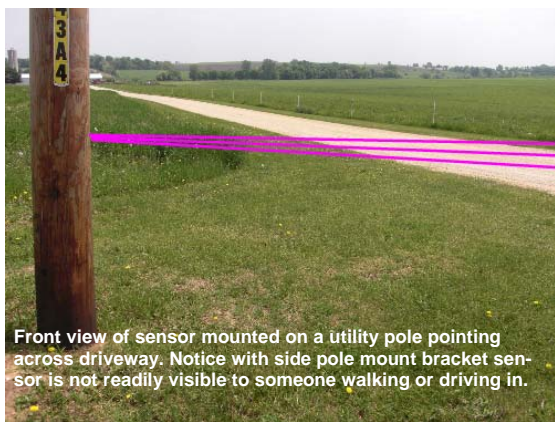
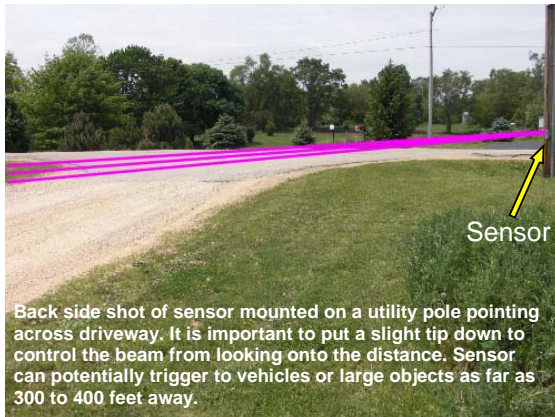

Specifications

Beam Length: 100 feet typical
Beam Width: 10 Feet approximate

Transmission: 900 Mhz Digital Signal Processing

Battery Life: Average 3 to 5 Years

Warranty/Disclaimer

Jansen Electronics "JE" warrants its products ("Product" or "Products") to conform to its own specifications and to be free of defects in materials and workmanship under normal use for a period of 12 months (unless otherwise stated) from the date of purchase. Within the warranty period, JE will repair or replace, at its option, all or any part of the warranted product. JE will not be responsible for dismantling and or reinstallation charges. To exercise the warranty, the user ("user", "installer" or "consumer") must contact JE and receive a Return Material Authorization ("RMA") number by JE. This warranty is void in cases of improper installation, misuse, failure to follow installation and operating instructions, alteration, accident or tampering and repair by anyone other than JE.

This warranty is exclusive and expressly in lieu of all other warranties, obligations or liabilities, whether written, oral, express, or implied. There is no warranty by JE that JE product will be merchantable or fit for any particular purpose, nor is there any other warranty, expressed or implied, except as such is expressly set forth herein. In no event shall JE be liable for an incidental, consequential, indirect, special or exemplary damages, including but not limited to loss of profit, revenue, or contract, loss of use, cost of down time, or interruption of business, nor any claim made by distributor's customers or any other person or entity. This warranty will not be modified or extended. JE does not authorize any person to act on its behalf to modify or extend this warranty. This warranty will apply only to JE products. JE will not be liable for any direct, incidental or consequential damage or loss whatsoever, caused by the malfunction of product due to products, accessories, or attachments of other manufacturers, including batteries, used in conjunction with JE products.

Caution: Changes or modifications to this unit not expressly approved by Jansen Electronics may void the installer's authority to operate the equipment as well as the product warranty.

Xtralert

Long Range Digital Receiver

Installation and Operation Manual

1 Overview

The Xtralert digital receiver allows you to add up to four transmitters to any application. With diversity antenna reception and advanced digital signal processing, Jansen Electronics Xtralert technology is designed to minimize dead spots and existing RF interference in transmission areas to provide the most reliable signal transmission and longest sensor battery life available.

1.1 Jansen Electronics Contact Information

If you have any problems with this procedure, contact Jansen Electronics technical services:

- E-mail: info@jansenelectronics.com
- Phone: (815)232-3093

1.2 LEDs and Buttons

Alarm: Lights with the corresponding number of channel activated.

Tamper: Front panel of outdoor sensor is removed or not on properly.

Low Battery: The transmitter's 3 volt lithium battery is low and needs to be changed.

Inactive: This can mean several things. This digital system is supervised which means that the transmitter/s "check in" to the receiver silently every 4 hours. If the receiver does not have proper communication to the sensor this will "trigger" the inactive light. The receiver and/or transmitter needs to be relocated closer or better positioning. This is a great feature to ensure reliability of your wireless signal. Communication between components is the number one tech support call in wireless. Inactive can also be caused by low battery not being changed and the transmitter is totally dead.

Power Light: Lights up green when plugged in to the supplied AC adapter.

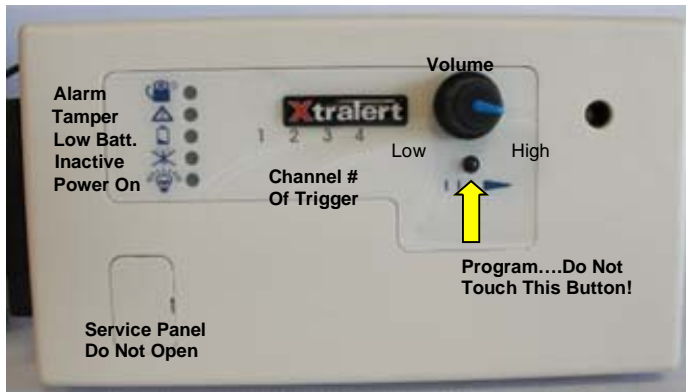

Do not set the receiver on the floor.

Do not set the receiver next to metal objects.

Do not set the receiver next to other wireless devices.

Please read our radio frequency do' and don'ts before installing.

It will take approximately 8 hours before the inactive light will light if you have a communication problem between the sensor and receiver. This system provides the only supervised wireless on the market.

Warranty/Disclaimer

Jansen Electronics "JE" warrants its products ("Product" or "Products") to conform to its own specifications and to be free of defects in materials and workmanship under normal use for a period of 12 months (unless otherwise stated) from the date of purchase. Within the warranty period, JE will repair or replace, at its option, all or any part of the warranted product. JE will not be responsible for dismantling and or reinstallation charges. To exercise the warranty, the user ("user", "installer" or "consumer") must contact JE and receive a Return Material Authorization ("RMA") number by JE. This warranty is void in cases of improper installation, misuse, failure to follow installation and operating instructions, alteration, accident or tampering and repair by anyone other than JE.

This warranty is exclusive and expressly in lieu of all other warranties, obligations or liabilities, whether written, oral, express, or implied. There is no warranty by JE that JE product will be merchantable or fit for any particular purpose, nor is there any other warranty, expressed or implied, except as such is expressly set forth herein. In no event shall JE be liable for an incidental, consequential, indirect, special or exemplary damages, including but not limited to loss of profit, revenue, or contract, loss of use, cost of down time, or interruption of business, nor any claim made by distributor's customers or any other person or entity. This warranty will not be modified or extended. JE does not authorize any person to act on its behalf to modify or extend this warranty. This warranty will apply only to JE products. JE will not be liable for any direct, incidental or consequential damage or loss whatsoever, caused by the malfunction of product due to products, accessories, or attachments of other manufacturers, including batteries, used in conjunction with JE products.

Caution: Changes or modifications to this unit not expressly approved by Jansen Electronics may void the installer's authority to operate the equipment as well as the product warranty.



3885 S Rock City Rd
Ridott, IL 61067
Phone: 815-232-3093
Fax: 815-232-3693
E Mail: info@jansenelectronics.com
www.jansenelectronics.com

LIMITED WARRANTY

Jansen Electronics, a division of RFR Inc. and its subsidiaries and affiliates ("Seller") warrants its products to be free from defects in materials and workmanship under normal use for 12 or 24 months (product dependant) from the date of sale. Because Seller does not install or connect the product and because the product may be used in conjunction with products not manufactured by Seller, Seller can not guarantee the performance of the security system which uses the product. Seller's obligation and liability under this warranty is expressly limited to repairing or replacing, at Sellers option, within a reasonable time after the date of delivery, any product not meeting the specifications.

SELLER MAKES NO OTHER WARRANTY, EXPRESSED OR IMPLIED, AND MAKES NO WARRANTY OF MERCHANTABILITY OR OF FITNESS FOR ANY PARTICULAR PURPOSE. IN NO CASE SHALL SELLER BE LIABLE FOR ANY CONSEQUENTIAL OR INCIDENTAL DAMAGES FOR BREACH OF THIS OR ANY OTHER WARRANTY, EXPRESSED OR IMPLIED, OR UPON ANY OTHER BASIS OF LIABILITY WHATSOEVER.

Seller's obligation under this warranty shall not include any transportation charges or costs of installation or any liability for direct, indirect or consequential damages or delay. Seller does not represent that its products may not be compromised or circumvented by burglary, robbery, fire or otherwise; or that the product will in all cases provide adequate warning or protection. Buyer understands that a properly installed and maintained alarm may only reduce the risk of burglary, robbery, or fire without warning, but it is not insurance or a guarantee that such will not occur or that there will be no personal injury or property loss as a result.

CONSEQUENTLY, SELLER SHALL HAVE NO LIABILITY FOR ANY PERSONAL INJURY, PROPERTY DAMAGE OR OTHER LOSS BASED ON A CLAIM THAT THE PRODUCT FAILS TO GIVE WARNING. HOWEVER, IF SELLER IS HELD LIABLE WHETHER DIRECTLY OR INDIRECTLY, FOR ANY LOSS OR DAMAGE ARISING UNDER THIS LIMITED WARRANTY OR OTHERWISE, REGARDLESS OF CAUSE OF ORIGIN, SELLER'S MAXIMUM LIABILITY SHALL NOT IN ANY CASE EXCEED THE PURCHASE PRICE OF THE PRODUCT, WHICH SHALL BE THE COMPLETE AND EXCLUSIVE REMEDY AGAINST SELLER.

No employee or representative of Seller is authorized to change this warranty in any way or grant any other warranty.

WARNING: This product should be tested at least once a day.

Any returns or refunds from Jansen Electronics require a return authorization number for any reason. Call 815-232-3093 to obtain an RA#. Packages will be refused and returned to sender if no RA # is on written outside of package. No Refunds On Shipping Charges!

Proof of purchase from an authorized dealer of Jansen Electronics must be provided for all warranty claims. Once item is received and inspected, Jansen Electronics will have the option to repair or replace the defective product. Any alteration of the units serial # or units purchased from unauthorized dealers will void any warranty. Any misuse, physical or liquid damage, modifications, or alterations to product will void warranty.

Jansen Electronics is not responsible for any refunds for products purchased from authorized dealers. Consumer must contact dealer directly for their return procedures.

Return procedures for 30 day money back guarantee policy for products purchased directly from Jansen Electronics:

1. Call for a Return Authorization number (RA#) before sending the unit back 815-232-3093.
2. Product must be shipped back to Jansen Electronics within 30 days from receipt of product(s)
3. Original receipt must accompany the product for refunds and warranty issues.
4. Customer is responsible for proper shipping, packaging, and insurance to Jansen Electronics.
5. Any misuse, physical damage, liquid damage, or alteration to product will void refund policy and warranty.
6. Dealers will use their own standard return/restock policies.
7. Minimum 20% restock fee will apply to merchandise returned in used condition.
8. Items returned for full credit/refund must be in like new saleable condition with all manuals, accessories, original packaging with no cosmetic scratches, dents, or cracks, modifications, physical or electrical damage, misuse of product, etc.